

A large, light red graphic of the letters 'EZ' serves as a background. The 'E' is composed of several horizontal and vertical segments, while the 'Z' is formed by a series of connected diagonal and horizontal lines, creating a dynamic, architectural feel.

**dynamic ZM**

**DYNAMIC ZONE MIMIC®**

## FEATURES

- Compatible with both conventional and addressable systems
- Allows siting of fire alarm panel to an alternative location
- Large 21.5" LCD display
- Sleek unobtrusive design
- Displays active fire zones during an alarm condition without user intervention
- User configured media display
- Built-in fault output for monitoring
- Smart power saving mode conserves battery power during a mains failure
- Remote key switch test facility

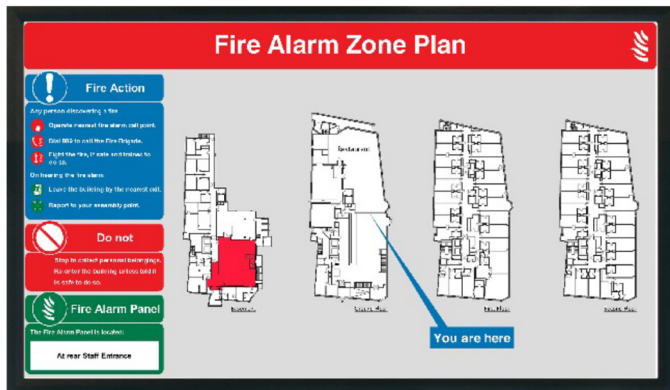

## DESCRIPTION

**dynamicZM** is a dynamic zone mimic® compatible with a range of fire alarm control panels, both addressable and conventional. Utilising a 21.5" LCD display, during a fire alarm event **dynamicZM** automatically overrides all media and displays an active fire alarm zone plan, clearly identifying the zone or zones in an alarm condition. Where multiple zones are in an alarm condition, the first zone to be activated (or zone of origin) is identified with a flashing zone boundary. For linked or non-fire zones separate images or messages can be displayed.

Upon the clearing of alarm conditions and a successful reset of the fire alarm system, **dynamicZM** will revert to the user's media display schedule. No user intervention is required at the **dynamicZM** location either for displaying fire alarm zones in alarm or resetting the fire alarm system.

A general fault output is provided to monitor **dynamicZM**. Should the data connection be lost between the fire alarm control panel and **dynamicZM**, the data fault message will be displayed, and the fault output activated. A suitable PSU complete with a fault relay should be used with **dynamicZM**. When the PSU fault relay is activated **dynamicZM** will enter power saving mode to preserve operation via batteries only. In this scenario, the general fault output will also be activated.

A test facility is provided to enable the connection of a remote test switch. Activation of a connected test switch displays the fire alarm zone plan to enable a periodic check of its accuracy, without activation of the main fire alarm system. This displays for 90 seconds before automatically reverting to the user's media display schedule.

**dynamicZM** can be configured on demand by the end user to display their chosen images and silent video media, without the intervention of a fire alarm engineer. Each **dynamicZM** comes with free access to an online media manager dashboard to configure media and schedules ready for local deployment to **dynamicZM** with a mobile device via Wi-Fi.

**dynamicZM** is flush mounted as standard, offering a sleek and unobtrusive design suitable for numerous applications.

## COMPATIBILITY

**dynamicZM** is compatible with a range of conventional and addressable fire alarm panels from:



# SUITABLE FOR

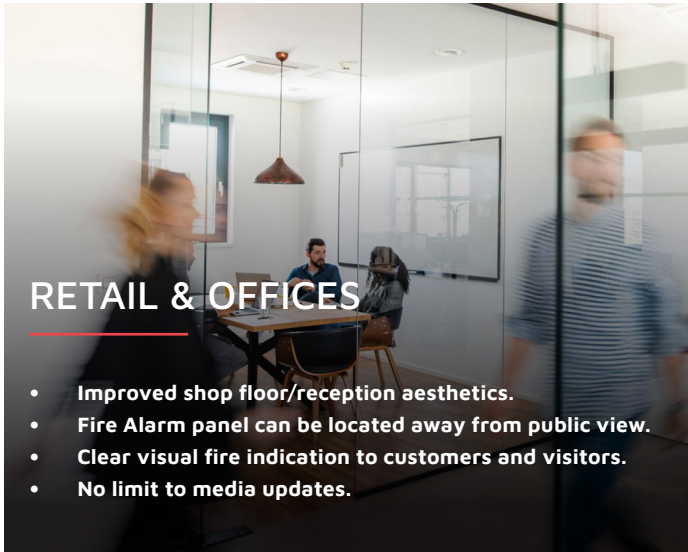

## RETAIL & OFFICES

- Improved shop floor/reception aesthetics.
- Fire Alarm panel can be located away from public view.
- Clear visual fire indication to customers and visitors.
- No limit to media updates.

An ideal solution for improved aesthetic appearance in shops and offices, **dynamicZM** allows for the fire alarm panel to be located away from constant view and possible public interference. In the event of a fire alarm activation, **dynamicZM** will automatically display clear information tailored for your premises, eliminating any confusion for staff, customers, or visitors. With no limit to media updates, your **dynamicZM** can keep up with current retail offers or company sales and marketing messages.



## EDUCATION

- Fire alarm panel can be located away from public view or interference.
- Clear visual fire indication to visitors at reception.
- No limit to media updates.
- Non-fire zones display their own specific messages.

**dynamicZM** allows for the fire alarm panel to be located away from constant view and possible public interference in educational premises. In the event of a fire alarm activation, **dynamicZM** will automatically display clear information, eliminating any confusion for staff, pupils, or visitors. Fire alarm zones used for non-fire events, such as lockdown, can display specific information tailored for your school or college. With no limit to media updates, your **dynamicZM** can keep up with current notices for parents and pupils.



## INDUSTRY

- Media can be used for essential site safety information.
- Clear visual fire indication and information to site visitors.
- Immediate fire alarm location to aid rapid response.
- Non-fire zones display their own specific messages.

Unlimited media updates make **dynamicZM** an important part of crucial site safety in industrial settings. Key health and safety information can be displayed and kept up to date, keeping staff and visitors safe. In the event of a fire alarm activation, **dynamicZM** can automatically display the origin of the alarm clearly, eliminating any confusion and aiding rapid response. Fire alarm zones used for non-fire events, such as gas alarms, can display specific information tailored for your site.

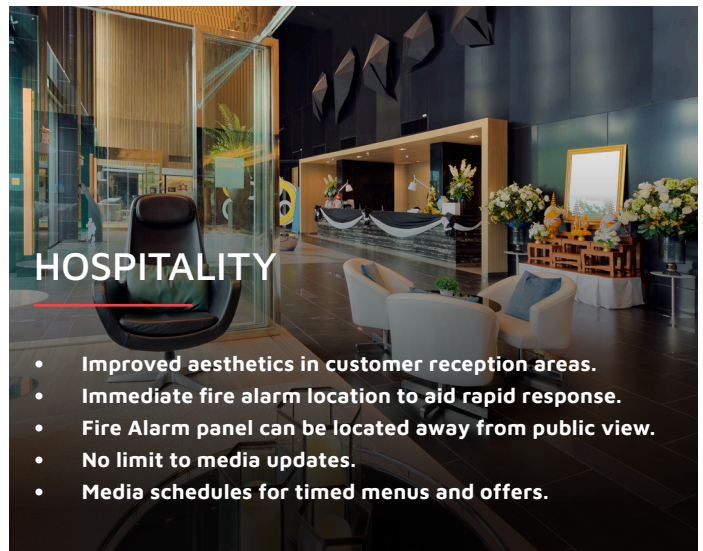

## HOSPITALITY

- Improved aesthetics in customer reception areas.
- Immediate fire alarm location to aid rapid response.
- Fire Alarm panel can be located away from public view.
- No limit to media updates.
- Media schedules for timed menus and offers.

An ideal solution for improved aesthetic appearance in hospitality venues, **dynamicZM** allows for the fire alarm panel to be located away from constant view and possible public interference. In the event of a fire alarm activation, **dynamicZM** displays clear fire information automatically. With no limits to media updates, it's easy to ensure current offers are always displayed. Utilising the media schedules, you can also create timed media displays for specific daily menus or offers.

# dynamicZM SOLUTIONS

## SITING OF THE FIRE ALARM CONTROL PANEL

Indication of a fire alarm activation should be in the main entrance to the premises, which includes the fire alarm control panel and zone plan. Particularly in retail, hospitality and educational environments this also means the control panel will be in a public area and may be subject to interference. Additionally, to suit the strong brand aesthetics in premises such as these, the fire alarm panel may be concealed from view making the identification of the zone in alarm more difficult following an activation.

### SOLUTION

Sited in a prominent position at the premises entrance, dynamicZM displays the zone in alarm automatically on the building plan, allowing the relocation of the fire alarm control panel and zone plan. The sleek design of the 21" screen makes dynamicZM the ideal choice to also improve interior design aesthetics as well as making identification of a fire alarm activation easy. With full media control, dynamicZM can be used to display the users chosen media images, videos and live feeds at all other times.

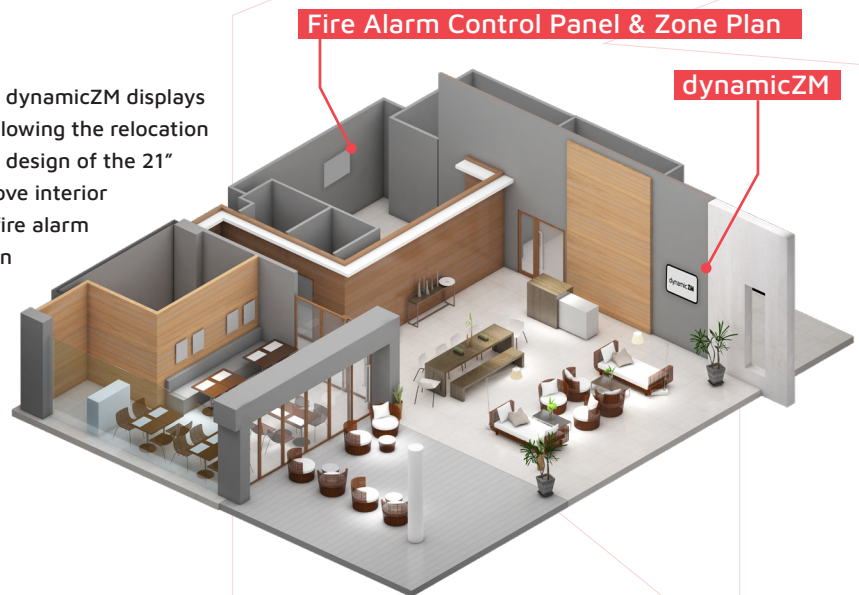

## LINKED FIRE ALARM ZONES – RETAIL & HOSPITALITY

In retail and hospitality settings when fire alarm systems have zones linked to other inputs, such as the shopping centre main fire alarm (usually referred to as Landlord link) and the sprinkler system, these are noted on the fire alarm zone plan. But what do they mean, and what action should be taken when one of these linked zones is activated?

### SOLUTION

With bespoke images for linked zones dynamicZM makes all fire alarm activations easy to understand.



Example – landlord fire alarm system has been activated

## FIRE ALARM WEEKLY TESTS – PUBLIC NOTIFICATION

The mandatory weekly fire alarm test can cause confusion for customers or visitors. Staff are usually familiar with the procedure, date and time of the weekly test but visitors or customers need to be informed to avoid any confusion.

### SOLUTION

Utilising the full media online dashboard with dynamicZM, the media can be set to automatically display a warning to customers and visitors that the fire alarm system will activate shortly and that this is just a test and no need for any concern or action.

For example, if the fire alarm is tested on a Tuesday, at 10:00 am, using the comprehensive media scheduling tools the following image could be automatically displayed between 9:45am and 10:00 am every Tuesday.

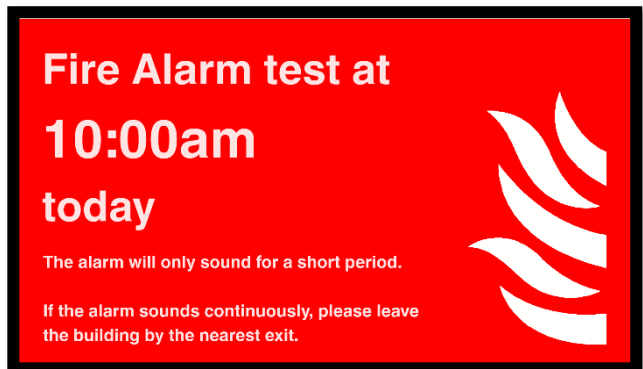

## LINKED FIRE ALARM ZONES – EDUCATION

In educational settings when fire alarm systems have zones linked to other inputs, such as a lockdown alarm, these are noted on the fire alarm zone plan. But what do they mean, and what action should be taken when this is activated?

### SOLUTION

With bespoke images for linked zones dynamicZM makes all fire alarm activations easy to understand.

For example, when a zone on the fire alarm is used for lockdown, it may activate intermittent or pulsing sounders, or different coloured flashing beacons so that staff can quickly invoke their lockdown safety procedures. But any visitors, particularly parents, may be confused to find the alarms sounding and access restricted with no sign of an evacuation.

When dynamicZM is used in the main entrance, the lockdown zone can be programmed to display an image such as this:





## LINKED FIRE ALARM ZONES – INDUSTRIAL SITES

Overall safety is paramount in industrial applications, and additional plant alarms are often integrated into the fire alarm system. A quick and effective response is key, so unambiguous messaging on any alarm activation is essential.

### SOLUTION

dynamicZM boasts a comprehensive user managed media dashboard which can be used for critical site safety notices, with scheduling features to automate messaging based on the precise time of the day. With specific images for linked zones too, dynamicZM makes all alarm activations from the fire alarm system easy to understand.

For example, when a zone on the fire alarm is used for a gas alarm a bespoke image can be applied to dynamicZM to communicate the required response in that particular building or area of the site.

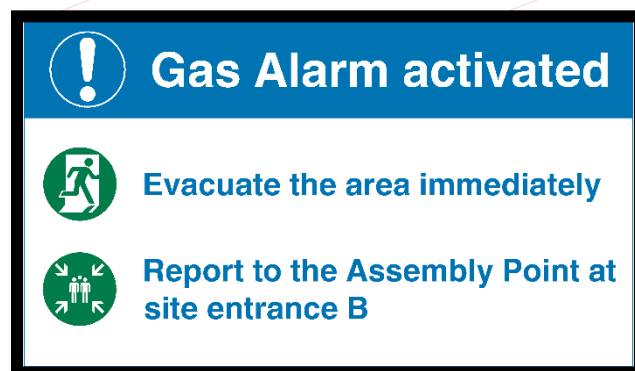

## HIGH DEPENDENCY BUILDINGS – FIRE ALARM ZONING

In high dependency buildings where evacuation can be more complex, identifying the source of alarm quickly is paramount. Often, individual fire zones are allocated to each bedroom or ward but even with the correctly printed fire alarm zone plan on display, locating the small zone of alarm can be difficult when the plan is showing all zones present on the system.

### SOLUTION

dynamicZM only identifies the zone(s) in alarm, leaving the remaining parts of the building clear for quick and effective identification of the area in alarm. In these high dependency premises, the fire alarm activation from a specific bedroom can be seen clearly allowing for the most rapid response from both staff and the emergency services on arrival.

In this example, a single bedroom has been highlighted as the zone in alarm with the rest of the building clear to easily identify the quickest route to the bedroom.





dynamic **ZM**

DYNAMICZM.COM