

Fire

Fire Action

- On discovering a fire
 - Operate nearest fire alarm call point.
 - Dial 999 to call the Fire Brigade.
 - Fight the fire, if safe and trained to do so.
- On hearing the fire alarm
 - Leave the building by the nearest exit.
 - Report to your assembly point.



Do not

Stop to collect personal belongings.
Re-enter the building unless told it is safe to do so.



Fire Alarm Panel

The Fire Alarm Panel is located:

School Reception Office



dynamic ZM

DYNAMIC ZONE MIMIC®

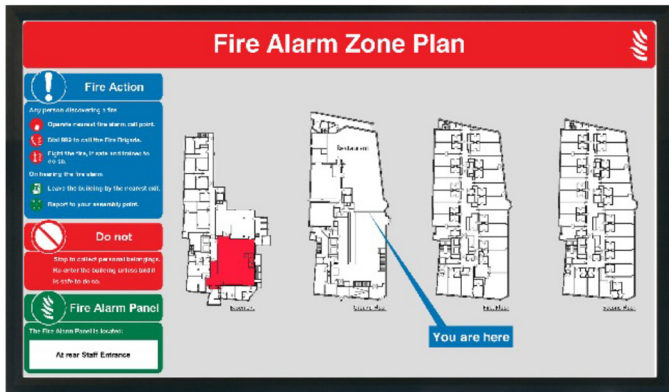

FEATURES

- Compatible with both conventional and addressable systems
- Large 21.5" LCD display
- Displays active fire zones without user intervention
- Built-in fault output for monitoring
- Remote key switch test facility
- Cloud based media control option
- Pre-configured with site plan and zoning

DESCRIPTION

dynamicZM is a dynamic zone mimic® compatible with a range of addressable and conventional fire alarm control panels from leading manufacturers. Using a large 21.5" LCD screen it displays any active fire alarm zones onto a plan of the protected premises automatically without any user intervention.

Where fire alarm zones are used for remote inputs or non-fire events, specific and bespoke messaging can be applied relating the activated zone on the fire alarm panel.

At all other times **dynamicZM** displays scheduled media content. This can be set at commissioning stage or controlled by the end user through an online media manager platform.

Utilising the power of Yodeck, show eye-catching media on all your **dynamicZM** devices with the push of a button. Just drag & drop your own media into the platform (or choose from thousands of free stock images and videos), and then click 'Push to Players'. For more information go to www.yodeck.com.

Commissioning and zone plan updates are made wirelessly with the **dynamicZM** Engineers Tool program and the on board wi-fi hotspot. Each device has it's own unique SSID credentials for secure connectivity.

dynamicZM is flush mounted as standard offering a sleek and unobtrusive design suitable for numerous applications.

COMPATIBILITY

dynamicZM is compatible with a range of conventional and addressable fire alarm panels from leading manufacturers.



SUITABLE FOR

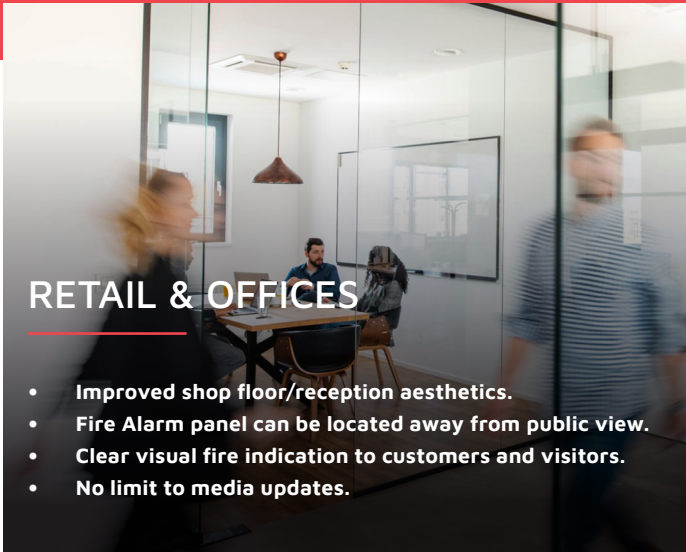

An ideal solution for improved aesthetic appearance in shops and offices, **dynamicZM** allows for the fire alarm panel to be located away from constant view and possible public interference. In the event of a fire alarm activation, **dynamicZM** will automatically display clear information tailored for your premises, eliminating any confusion for staff, customers, or visitors. With no limit to media updates, your **dynamicZM** can keep up with current retail offers or company sales and marketing messages.



dynamicZM allows for the fire alarm panel to be located away from constant view and possible public interference in educational premises. In the event of a fire alarm activation, **dynamicZM** will automatically display clear information, eliminating any confusion for staff, pupils, or visitors. Fire alarm zones used for non-fire events, such as lockdown, can display specific information tailored for your school or college. With no limit to media updates, your **dynamicZM** can keep up with current notices for parents and pupils.



Unlimited media updates make **dynamicZM** an important part of crucial site safety in industrial settings. Key health and safety information can be displayed and kept up to date, keeping staff and visitors safe. In the event of a fire alarm activation, **dynamicZM** can automatically display the origin of the alarm clearly, eliminating any confusion and aiding rapid response. Fire alarm zones used for non-fire events, such as gas alarms, can display specific information tailored for your site.

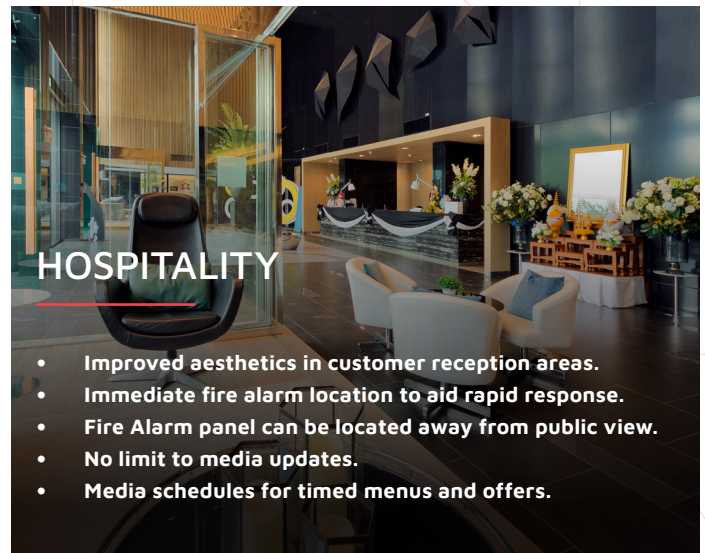

An ideal solution for improved aesthetic appearance in hospitality venues, **dynamicZM** allows for the fire alarm panel to be located away from constant view and possible public interference. In the event of a fire alarm activation, **dynamicZM** displays clear fire information automatically. With no limits to media updates, it's easy to ensure current offers are always displayed. Utilising the media schedules, you can also create timed media displays for specific daily menus or offers.

MEDIA

At all other times, **dynamicZM** displays scheduled media content. This can be set at commissioning stage by the installer or controlled by the end user through an online media manager platform.

DynamicZM is compatible with any digital signage platform that supports web browser signage players. We recommend the use of Yodeck, a powerful platform for creating engaging content easily.



yodeck overview

Easy to use

We want you to focus on your business, not your signage. Just drag & drop any pics, videos & docs into our platform. Then, it only takes one click to get it on **dynamicZM**, with remote screen management.

Easy-to-create playlists and easy-to-customize free templates get your updates on screen & looking great in no time.

We also have a full library of short video tutorials, that take you from setup to expert user.

Base. Access easy-to-follow tutorial videos and guidance to help you create the most eye catching content for your **dynamicZM**.

Secure

Trust our superb security features, which make our software and hardware tamper-proof. No worries with Yodeck!

Display any type of content

Use your own photos and videos, or choose from thousands of free stock media from our Galleries. Also, create engaging experiences using interactive content.

It only takes a few clicks to edit, update and display your content in real time, straight from our online platform, no matter where you are.

Support

We've got you covered with the Yodeck Academy and Knowledge Base. Access easy-to-follow tutorial videos and guidance to help you create the most eye catching content for your **dynamicZM**.

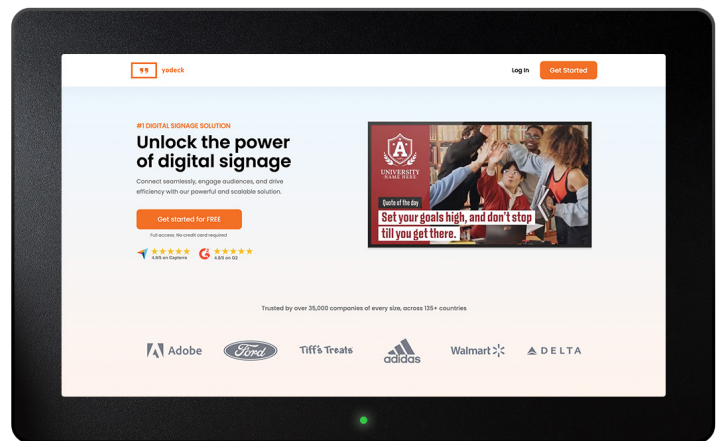

FOR MORE INFORMATION, VISIT WWW.YODECK.COM



dynamicZM

SOLUTIONS

Siting of the Fire Alarm Control panel

Indication of a fire alarm activation should be in the main entrance to the premises, which includes the fire alarm control panel and zone plan. Particularly in retail, hospitality and educational environments this also means the control panel will be in a public area and may be subject to interference. Additionally, to suit the strong brand aesthetics in premises such as these, the fire alarm panel may be concealed from view making the identification of the zone in alarm more difficult following an activation.

SOLUTION

Sited in a prominent position at the premises entrance, dynamicZM displays the zone in alarm automatically on the building plan, allowing the relocation of the fire alarm control panel and zone plan. The sleek design of the 21" screen makes dynamicZM the ideal choice to also improve interior design aesthetics as well as making identification of a fire alarm activation easy. With full media control, dynamicZM can be used to display the users chosen media images, videos and live feeds at all other times.



Linked fire alarm zones – Retail & Hospitality

In retail and hospitality settings when fire alarm systems have zones linked to other inputs, such as the shopping centre main fire alarm (usually referred to as Landlord link) and the sprinkler system, these are noted on the fire alarm zone plan. But what do they mean, and what action should be taken when one of these linked zones is activated?

SOLUTION

With bespoke images for linked zones dynamicZM makes all fire alarm activations easy to understand.



Example – landlord fire alarm system has been activated

dynamicZM

SOLUTIONS

Fire Alarm weekly tests - public notification

The mandatory weekly fire alarm test can cause confusion for customers or visitors. Staff are usually familiar with the procedure, date and time of the weekly test but visitors or customers need to be informed to avoid any confusion.

SOLUTION

Utilising the full media online dashboard with dynamicZM, the media can be set to automatically display a warning to customers and visitors that the fire alarm system will activate shortly and that this is just a test and no need for any concern or action.

For example, if the fire alarm is tested on a Tuesday, at 10:00 am, using the comprehensive media scheduling tools the following image could be automatically displayed between 9:45am and 10:00 am every Tuesday.

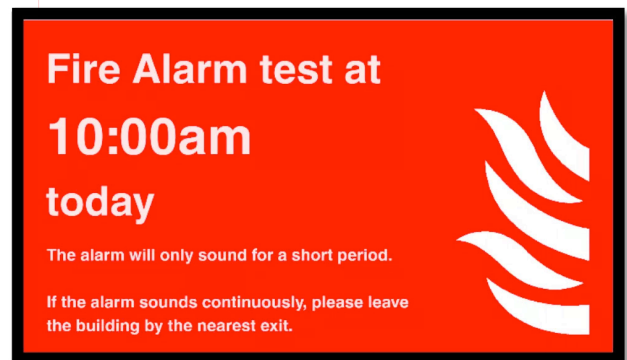

Linked fire alarm zones – Education

In educational settings when fire alarm systems have zones linked to other inputs, such as a lockdown alarm, these are noted on the fire alarm zone plan. But what do they mean, and what action should be taken when this is activated?

SOLUTION

With bespoke images for linked zones dynamicZM makes all fire alarm activations easy to understand.

For example, when a zone on the fire alarm is used for lockdown, it may activate intermittent or pulsing sounders, or different coloured flashing beacons so that staff can quickly invoke their lockdown safety procedures. But any visitors, particularly parents, may be confused to find the alarms sounding and access restricted with no sign of an evacuation.

When dynamicZM is used in the main entrance, the lockdown zone can be programmed to display an image such as this:



dynamicZM

SOLUTIONS

Linked fire alarm zones – Industrial sites

Overall safety is paramount in industrial applications, and additional plant alarms are often integrated into the fire alarm system. A quick and effective response is key, so unambiguous messaging on any alarm activation is essential.

SOLUTION

dynamicZM boasts a comprehensive user managed media dashboard which can be used for critical site safety notices, with scheduling features to automate messaging based on the precise time of the day. With specific images for linked zones too, dynamicZM makes all alarm activations from the fire alarm system easy to understand.

For example, when a zone on the fire alarm is used for a gas alarm a bespoke image can be applied to dynamicZM to communicate the required response in that particular building or area of the site.

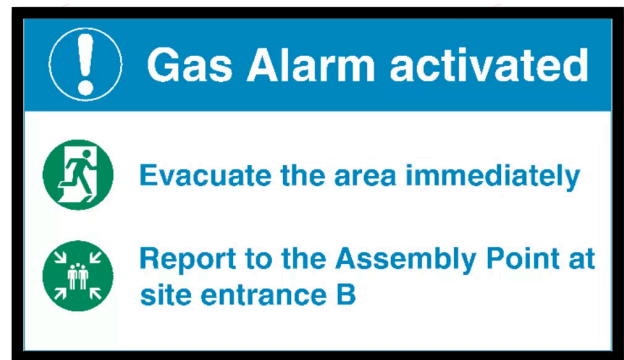

High rise buildings

In high rise buildings, the information available to the Fire and Rescue Service (FRS) on arrival is crucial. The Fire Safety (England) Regulations 2022 made it a legal requirement from 23 January 2023 for responsible persons of high-rise residential buildings in England to draw up and share electronically up-to-date floor plans identifying the location of key fire-fighting equipment with their local fire and rescue services.

SOLUTION

dynamicZM can be configured using the information commonly seen on an externally fixed Premises Information Plate.

On arrival to a fire alarm activation, dynamicZM will display the premises information to the FRS, showing the layout of the ground floor and upper floors while also showing the floor(s) in alarm with a clear red colour. Additionally, the floor of origin will be flashing while additional floors in alarm remain a solid red colour, directing the FRS to the cause of the alarm and indicating potential fire spread.

At all other times, dynamicZM can be utilised by the building managers to display useful information and notices to residents.



dynamic ZM

DYNAMICZM.COM